

Adjustable Rotary Tumbler

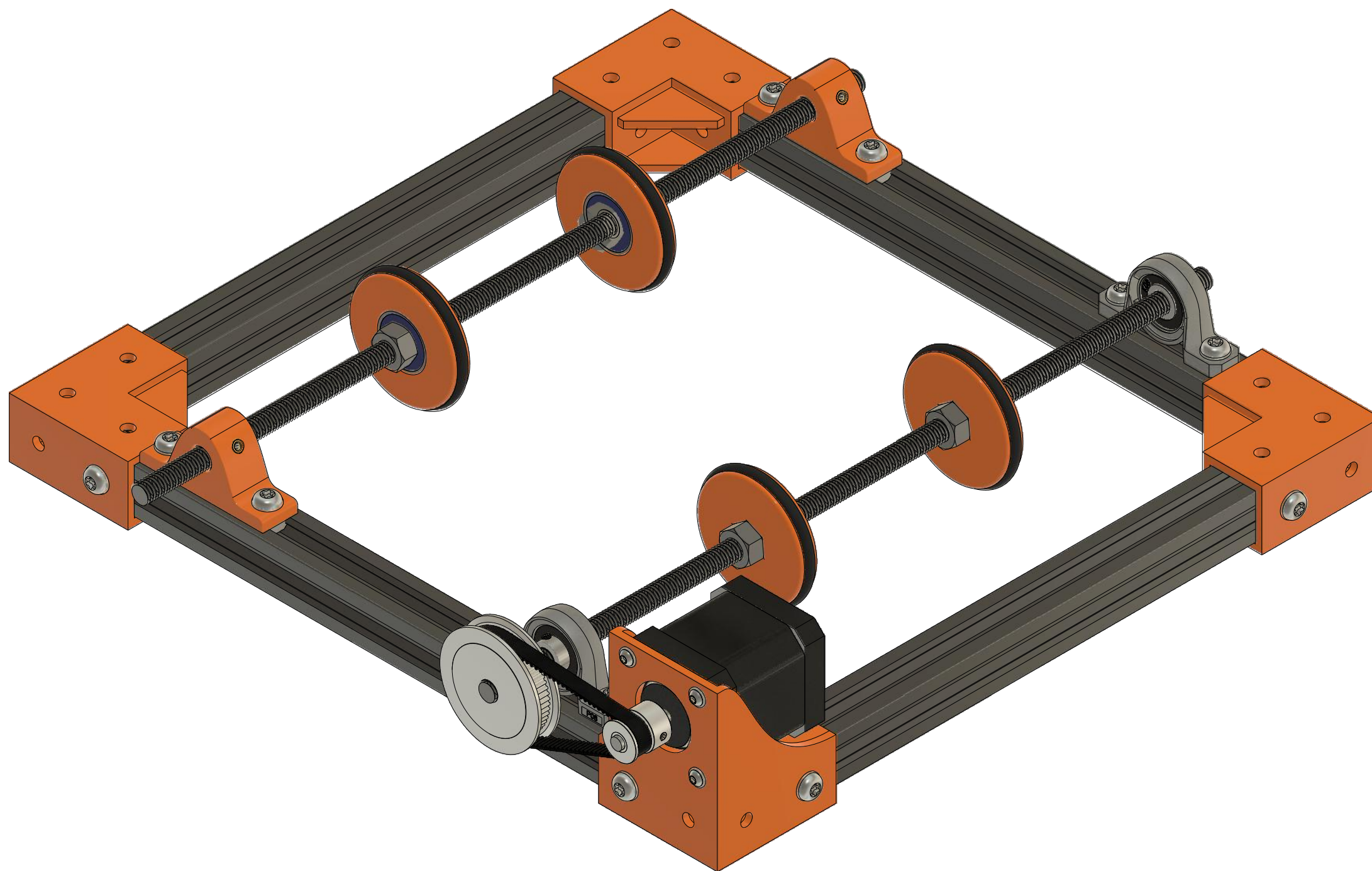

Overview

2/7

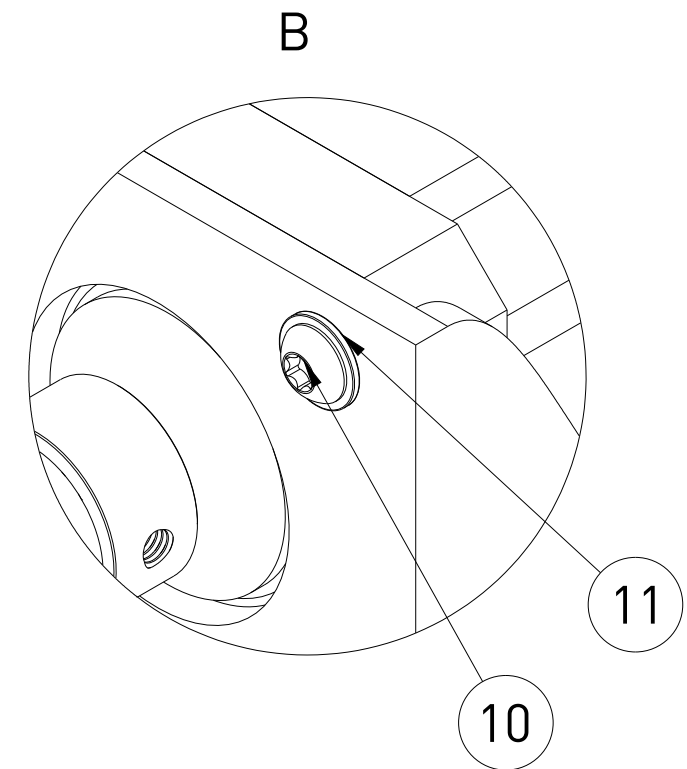
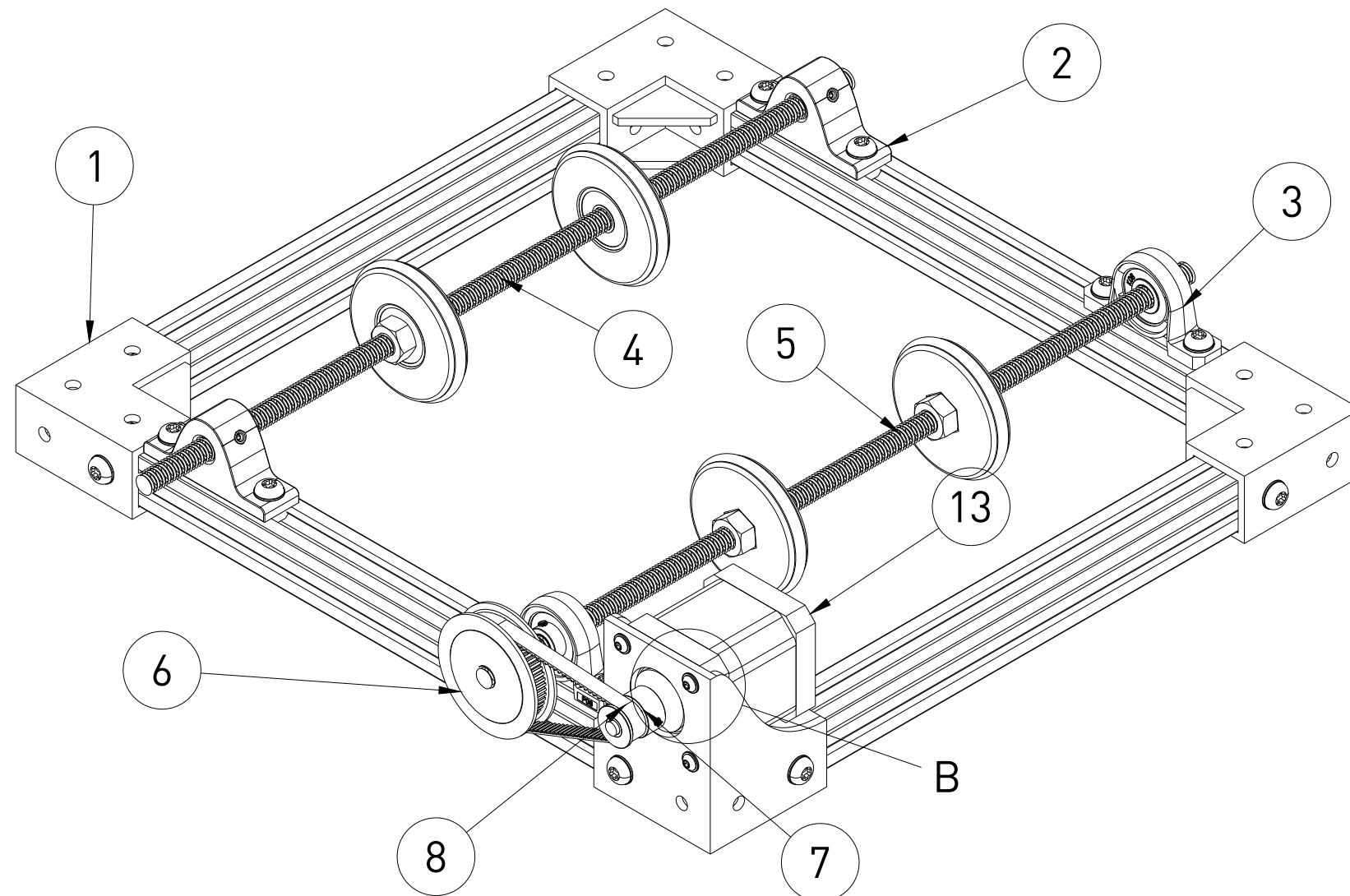

Parts List

Item	Qty	Part Number	Description	Material
1	1	YUMMY	Rotary Tumbler Frame Assembly	
2	2	FEEBLE	Pillow Block for fixed axle	
3	2	ILLEGAL	Pillow Block for driven axle	
4	1	FALSE	Fixed Axle Assembly	
5	1	DIALS	Driven Axle Assembly	
6	1	TIMELY GT2 60x6	Pulley 60 teeth for GT2 timming belt	Aluminum
7	1	TIMELY GT2 20x6	Pulley 20 teeth for GT2 timming belt	Aluminum
8	1	MELT GT2 200	Timming Belt GT2x6mm 200 mm	Rubber, Black
10	4	PHASE M3x8	TORX pan head screw, ISO7380-1 M3x8	Stainless Steel A2-70
11	4	WARD 6x3x.6	Washer DIN 988 6x3x0.6	Stainless Steel A2-70
13	1	SERMON 17	Stepper Motor NEMA 17	

Part: YUMMY

3/7

Parts List				
Item	Qty	Part Number	Description	Material
1	2	APOLLO 20x20x250	Aluminium profile V-Slot 20x20x250	Aluminum
2	2	APOLLO 20x20x270	Aluminium profile V-Slot 20x20x270	Aluminum
3	3	OREO 2020	3D printed corner connector for 20x20	PETG
4	1	OCEAN 17 2020	3D printed corner connector for 2020 profiles with integrated NEMA 17 mount	PETG
5	8	PHASE 5x10	TORX pan head screw, ISO7380-1 M5x10	Stainless Steel A2-70
6	8	WARD 10x5x1	Washer DIN 9021 10x5x1	Stainless Steel A2-70
7	8	SIL0 T20/5	Sliding block for T-nut 20 M5	Stainless Steel A2-70

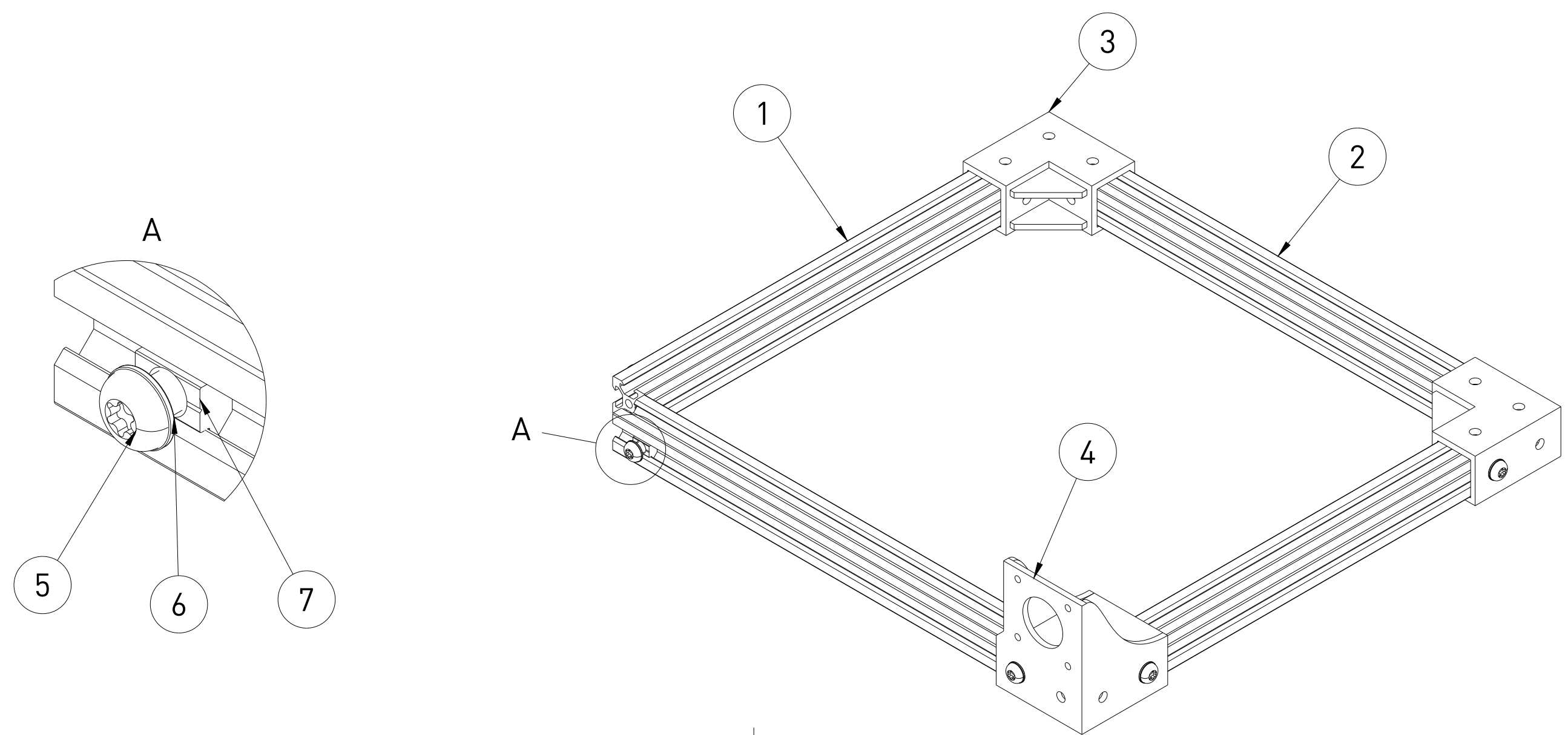

1

2

3

4

5

6

7

8

A

B

C

D

E

F

Part: FALSE

1

2

3

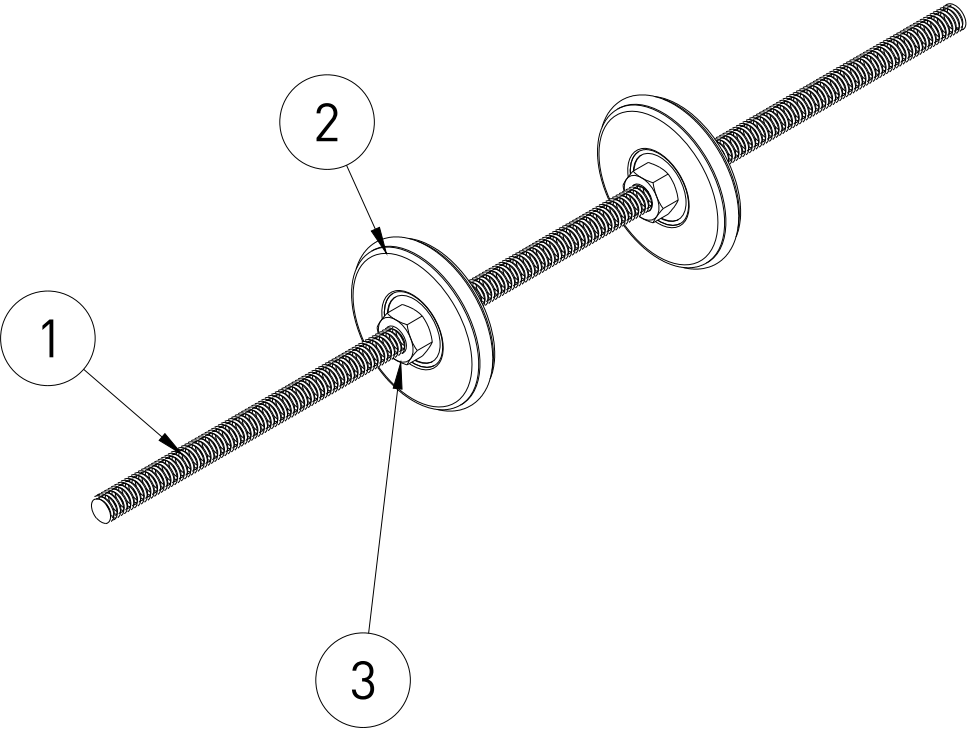

Part: DREAMY

4

5

6

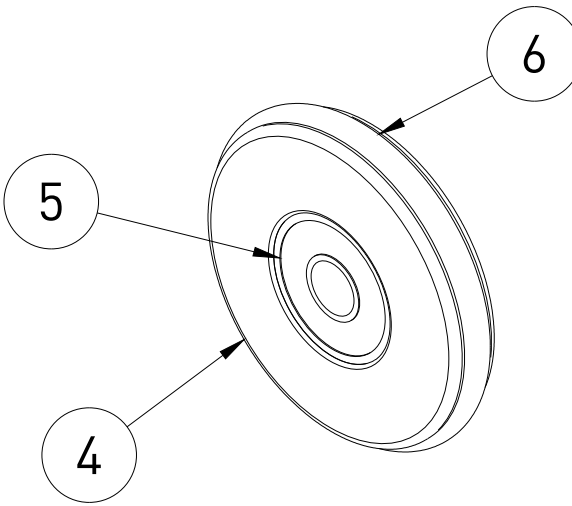

Parts List				
Item	Qty	Part Number	Description	Material
1	1	TREAD 8x320	Threaded Rod M8x320	Steel
2	2	DREAMY	Idler Wheel Assembly	
3	4	HUT 8	Hexagon nut M8	Steel

Parts List				
Item	Qty	Part Number	Description	Material
4	1	REEL	3D printed idler wheel	PETG
5	1	BABE 608	Ball bearing 608	Steel
6	1	GAIN 50x40x5	Gasket Ring (O-Ring) OD 50 x ID 40x 5	Silicon Nitride

4/7

Part: DIALS

5/7

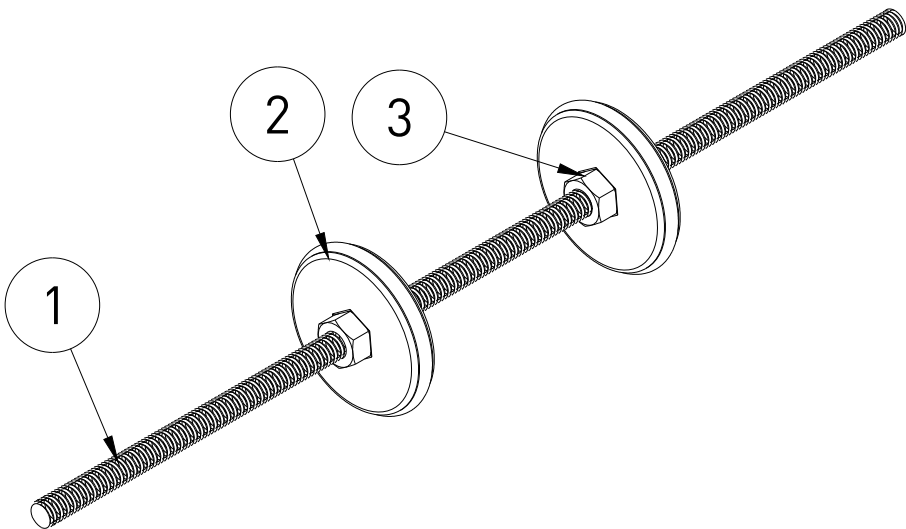

Parts List				
Item	Qty	Part Number	Description	Material
1	1	TREAD 8x320	Threaded Rod M8x320	Steel
2	2	REHAB	Drive Wheel Assembly	
3	4	HUT 8	Hexagon nut M8	Steel

Part: REHAB

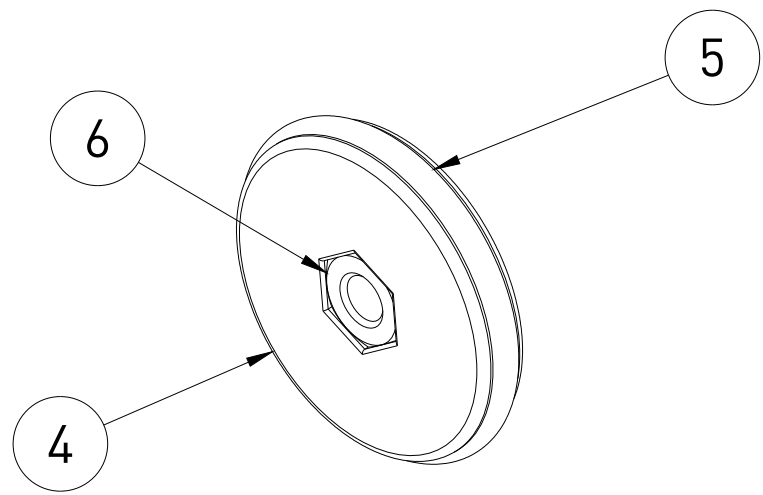

Parts List				
Item	Qty	Part Number	Description	Material
4	1	DRIVEL	3D printed drive wheel	PETG
5	1	GAIN 50x40x5	Gasket Ring (O-Ring) OD 50 x ID 40x 5	Silicon Nitride
6	1	HUT 8	Hexagon nut M8	Steel

Part: FEEBLE

6/7

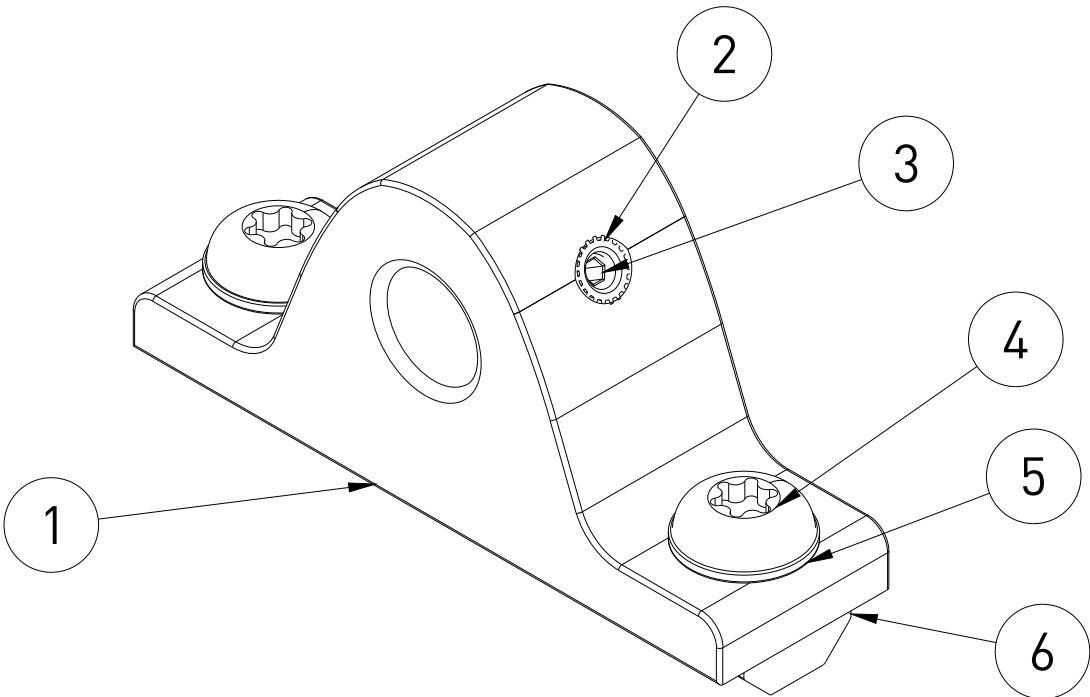

Parts List				
Item	Qty	Part Number	Description	Material
1	1	FIDEL	3D printed bearing block with screws, nuts and washers	PETG
2	2	REFUTE 3x5,7	RUTHEX fusible thread M3x5,7	Brass
3	2	HADES 3x5	Headless screw M3x5	Stainless Steel
4	2	PHASE 5x10	TORX pan head screw, ISO7380-1 M5x10	Stainless Steel A2-70
5	2	WARD 10x5x1	Washer DIN 9021 10x5x1	Stainless Steel A2-70
6	2	SILO T20/5	Sliding block for T-nut 20 M5	Stainless Steel A2-70

Part: ILLEGAL

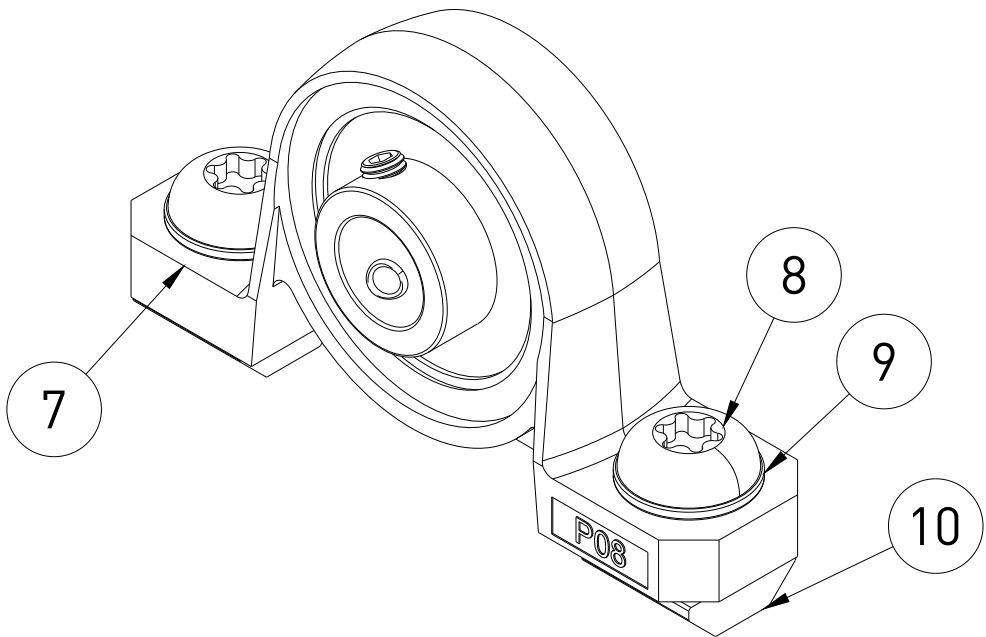

Parts List				
Item	Qty	Part Number	Description	Material
7	1	PILE 08	Pillow Block Bearing P08	
8	2	PHASE 5x10	TORX pan head screw, ISO7380-1 M5x10	Stainless Steel A2-70
9	2	WARD 10x5x1	Washer DIN 9021 10x5x1	Stainless Steel A2-70
10	2	SILO T20/5	Sliding block for T-nut 20 M5	Stainless Steel A2-70